

# Proximity switch for T-slot

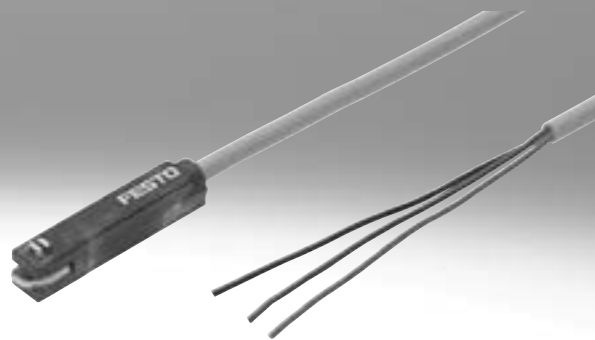

Festo Core Range  
Solves the majority of your automation tasks

With the Festo Core Range, we have selected the most important products and functions from our broad product catalogue, and added the quickest delivery.

Worldwide: Quickest delivery – wherever, whenever  
Simply good: Expected high Festo quality  
Fast: Easy and fast to select

The Core Range offers you the best value for your automation tasks.



## Product range overview

Design	Type of mounting	Measuring principle	Type	Operating voltage range	Switching output	Switching element function	→ Page
<b>For T-slot</b>	<b>Standard</b>						
	Screw-clamped, insertable in the slot from above	Magnetic Hall	SDBT-MSX	10 ... 30 V DC	PNP/NPN, switchable	N/O / N/C contact, switchable	–
	Insertable in the slot from above, flush with the cylinder profile	Magneto-resistive	SMT-8M-A	5 ... 30 V DC	PNP	N/O contact	–
						N/C contact	
					NPN	N/O contact	
					Non-contacting, 2-wire	N/O contact	
	Insertable in the slot from above, flush with the cylinder profile	Magnetic reed	SME-8M	5 ... 30 V AC/DC	Contacting, bipolar	N/O contact	–
						N/C contact	
	Insertable in the slot lengthwise, flush with the cylinder profile	Magnetic reed	SME-8	12 ... 30 V AC/DC	Contacting, bipolar	N/O contact	7
				3 ... 230 V AC/DC		N/C contact	11
	Insertable in the slot lengthwise	Magneto-resistive	SMT-8G	10 ... 30 V DC	PNP, NPN	N/O contact	–
		Magneto-resistive	SMT-8-SL	10 ... 30 V DC	PNP	N/O contact	–
		Magnetic reed	SME-8-SL	10 ... 30 V AC/DC	Contacting, bipolar	N/O contact	7
	With accessories	Magneto-resistive	SMT-8-E	10 ... 30 V DC	PNP	N/O contact	–
					NPN		
		Magnetic reed	SME-8-E	12 ... 30 V DC	Contacting, bipolar	N/O contact	–
	3 ... 250 V DC						
				3 ... 230 V AC			
	<b>Corrosion-resistant</b>						
	Insertable in the slot from above, flush with the cylinder profile	Magneto-resistive	CRSMT-8M	5 ... 30 V DC	PNP	N/O contact	–
	<b>Welding-field-resistant</b>						
	Insertable in the slot from above, screw-clamped	Magneto-resistive	SDBT-BSW	10 ... 30 V DC	PNP	N/O contact	–
					Non-contacting, 2-wire		
With accessories	Magneto-inductive	SMT-8-E	10 ... 30 V DC	PNP	N/O contact	–	
							NPN
<b>Heat-resistant up to 120°C</b>							
Insertable in the slot lengthwise, flush with the cylinder profile	Magnetic reed	SME-8-...S6	0 ... 30 V AC/DC	Contacting, bipolar	N/O contact	11	
With accessories	Magnetic reed	SME-8-E-...S6	0 ... 30 V DC	Contacting	N/O contact	–	
			0 ... 30 V AC				
<b>To EU Explosion Protection Directive (ATEX)</b>							
Insertable in the slot from above, screw-clamped	Magneto-resistive	SDBT-MS-...EX6	8.2 V DC	NAMUR	NAMUR	–	

## Product range overview

Design	Type of mounting	Measuring principle	Type	Operating voltage range	Switching output	Switching element function	→ Page	
For C-slot	Standard	Magneto-resistive	SMT-10M	10 ... 30 V DC	PNP	N/O contact	C-slot	
					NPN			
					Non-contacting, 2-wire			
	Insertable in the slot from above, flush with the cylinder profile	Magnetic reed	SME-10M	5 ... 30 V AC/DC	Contacting, bipolar	N/O contact		
		Insertable in the slot lengthwise	Magneto-resistive	SMT-10G	10 ... 30 V DC	PNP		N/O contact
			Magnetic reed	SME-10	12 ... 27 V AC/DC	Contacting		N/O contact

## T-slot switches can be used for drives with T-slot

## Exceptions

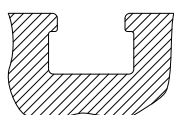

- DFM-B: SMT0-8E, SMTSO-8E, SME0-8E and SMP0-8E cannot be used
- DHDS: SME-8M can only be used on  $\varnothing 50$
- DHPS: SME-8M can only be used on  $\varnothing 20 \dots 35$
- HGDD-63-A: SMT-8M-A cannot be used
- HGPT-B: only SMT-8G can be used from size 40 and upwards
- SDBT-BSW- ... -PU/NU can only be used on a limited number of drive series. Page → 53

## C-slot switches can be used for drives with C-slot

## Exceptions

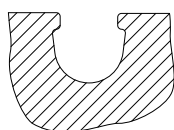

- ADVC  $\varnothing 100$ : SMT-10M and SME-10M cannot be used (ADVC has a T-slot and C-slot)
- DSM/DSM-B-6/8/10: SME-10M cannot be used
- DSM/DSM-B-1 0/16: SMT-10M cannot be used
- HGPT-B: only SMT-10G can be used for sizes up to and including size 35

## For drives with sensor rail: these are available with 2 cylinder barrel contours

Only T-slot switches CRSMT-8M, SMT-8M-A and SDBT-MS- ... -EX6 can be used, and only with the identified profile.

CRSMT-8M and SMT-8M-A can be used for all diameters; SDBT-MS- ... -EX6 cannot be used for diameters 40 and 50.

Example: DSBF

Example: CDC

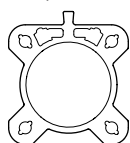

Suitable

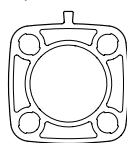

Not suitable

Peripherals overview

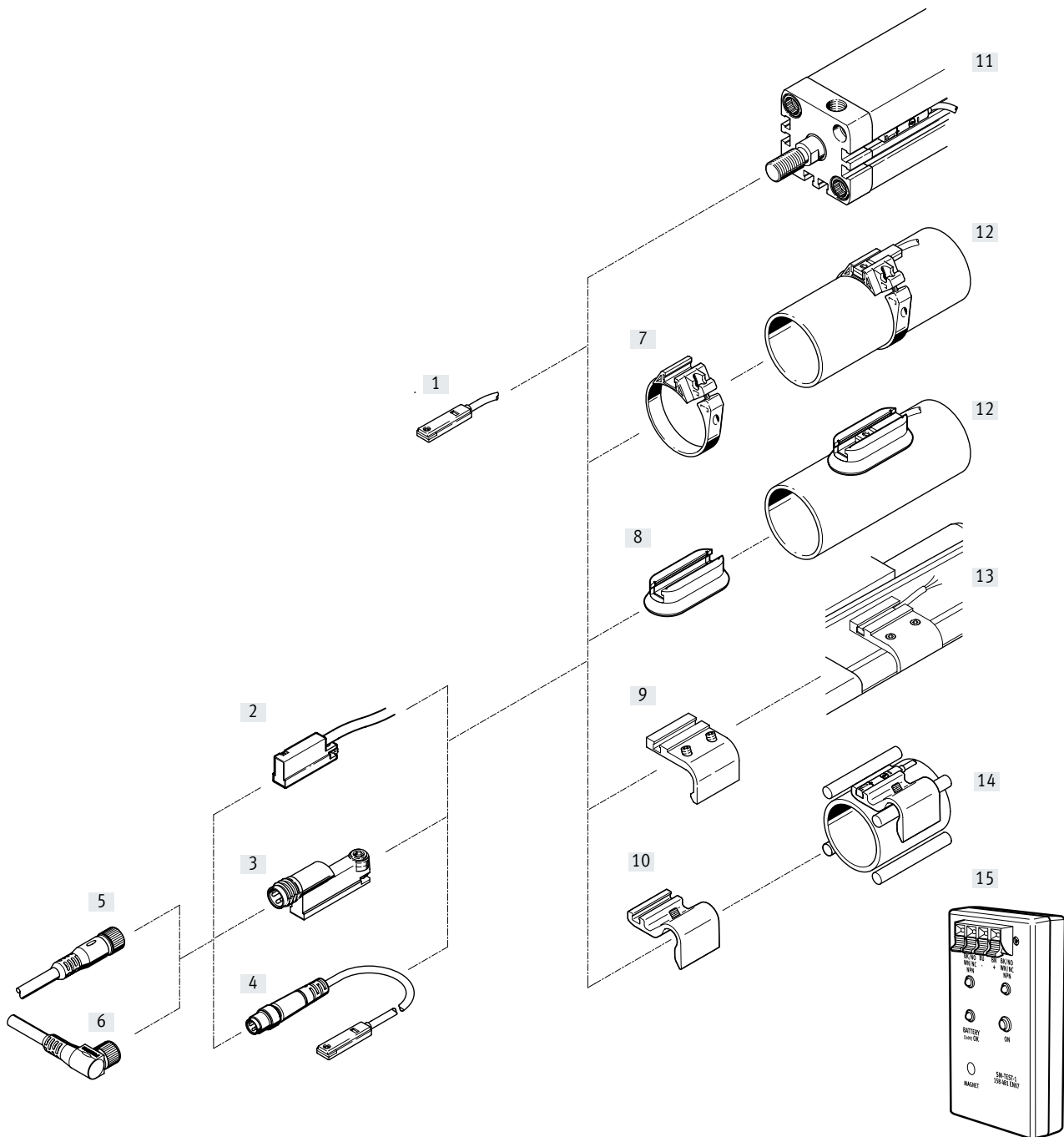

## Peripherals overview

Mounting components and accessories		→ Page	Mounting components and accessories		→ Page
<b>Proximity switches</b>			<b>Mounting kits and accessories</b>		
[1]	SME-8-K-..., with cable	7	[7]	Mounting kit SMBR	14
[2]	SME-8-K-LED-230	11	[8]	Mounting kit CRSMB, corrosion-resistant	15
[3]	SME-8-SL-..., with plug	7	[9]	Mounting kit SMB-8-FENG	15
[4]	SME-8-S-..., with cable and plug	7	[10]	Sensor bracket DASP-M4-...	16
			[15]	Sensor tester SM-TEST-1	17
			-	Positioning element SMM-8	16
			-	Clip SMBK-8	17
			-	Inscription label ASLR	17
			-	Safety clip NEAU	17
<b>Connecting cables</b>			<b>Drives</b>		
[5]	NEBU-M...G...	17	[11]	Drives with T-slot	-
[6]	NEBU-M...W...	17	[12]	Round cylinders	-
			[13]	Standards-based cylinders DSBC	-
			[14]	Drives with tie or mounting rod	-

## Type codes

001	Series
<b>SME</b>	Proximity sensor
002	Design type
<b>8</b>	For T-slot
003	Sensor version
	Inserted in the slot lengthwise
<b>SL</b>	Inserted in the slot lengthwise, sturdy due to long guides
004	Switching output
	None
<b>O</b>	N/C contact, 3-wire
<b>ZS</b>	2-wire PNP N/O contact
005	Switching status indication
	None
<b>LED</b>	Yellow LED

006	Rated operating voltage
<b>24</b>	24 V DC
<b>230</b>	230 V AC
007	Cable characteristic
	None
<b>K</b>	Standard/suitable for energy chains
008	Cable length [m]
<b>5,0</b>	5.0 m
<b>7,5</b>	7.5 m
009	Electrical connection
<b>OE</b>	Open end
<b>SL</b>	Plug

## Data sheet – Magnetic reed

## Function

N/O contact, with cable, 3-wire

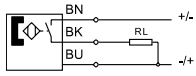

N/O contact, with plug

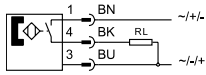

- Magnetic reed measuring principle
- Insertable in the slot lengthwise

**SME-8-SL**

- Sturdy thanks to long guides
- Plug directly on sensor

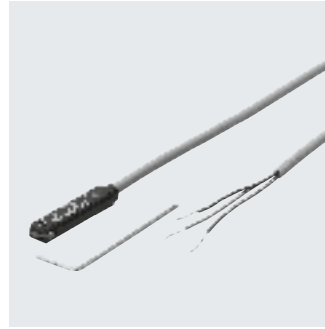

General technical data		SME-8-K	SME-8-S	SME-8-ZS	SME-8-O	SME-8-SL
Type						
Design		For T-slot				
Conforms to standard		EN 60947-5-2				
Certification		RCM compliance mark				
CE marking (see declaration of conformity)		To EU EMC Directive <sup>1)</sup>				
Note on materials		Free of copper and PTFE				
		RoHS-compliant	–	RoHS-compliant		

1) For information about the area of use, see the EC declaration of conformity at: [www.festo.com/sp](http://www.festo.com/sp) → Certificates.

If the devices are subject to usage restrictions in residential, commercial or light-industrial environments, further measures for the reduction of the emitted interference may be necessary.

Input signal/measuring element		SME-8-K	SME-8-K5	SME-8-K-7.5	SME-8-S	SME-8-ZS	SME-8-O	SME-8-SL
Type								
Measuring principle		Magnetic reed						
Ambient temperature	[°C]	–40 ... +60	–40 ... +70	–40 ... +70	–40 ... +70	–40 ... +60	–40 ... +60	–40 ... +60

Switching output		SME-8-K	SME-8-S	SME-8-ZS	SME-8-O	SME-8-SL
Type						
Switching output		Contacting, bipolar				
Switching element function		N/O contact	N/O contact	N/O contact	N/C contact	N/O contact
Reproducibility of switching value	[mm]	±0.1	±0.1	±0.1	±0.1	±0.1
Switch-on time	[ms]	≤ 0.5	≤ 0.5	≤ 0.5	≤ 2	≤ 0.6
Switch-off time	[ms]	≤ 0.03	≤ 0.03	≤ 0.03	≤ 0.2	≤ 0.05
Max. switching frequency	[Hz]	800	–	800	–	500
Max. output current	[mA]	500	500	80	50	500
Max. switching capacity AC	[VA]	10	10	–	1.5	10
Max. switching capacity DC	[W]	10	10	2.16	1.5	10
Voltage drop	[V]	0	–	≤ 3.5	≤ 2.5	0

Output, additional data	
Short circuit protection	No
Overload protection	Not present

Electronics		SME-8-K	SME-8-S	SME-8-ZS	SME-8-O	SME-8-SL
Type						
Operating voltage range	[V AC]	12 ... 30	12 ... 30	–	12 ... 30	10 ... 30
Operating voltage range	[V DC]	12 ... 30	12 ... 30	12 ... 27	12 ... 30	10 ... 30
Reverse polarity protection		No				

## Data sheet – Magnetic reed

Electromechanics							
Type	SME-8-K	SME-8-K5	SME-8-K-7.5	SME-8-S	SME-8-ZS	SME-8-O	SME-8-SL
Electrical connection	Cable, 3-wire			Cable with plug M8x1, 3-pin	Cable, 2-wire	Cable, 3-wire	Plug M8x1, 3-pin
Outlet direction of connection	In-line						
Cable length [m]	2.5	5	7.5	0.3	2.5	7.5	–
Information on materials: cable sheath	TPE-U (PUR)						–

Mechanics							
Type	SME-8-K	SME-8-K5	SME-8-K-7.5	SME-8-S	SME-8-ZS	SME-8-O	SME-8-SL
Type of mounting	Clamped in T-slot Insertable in the slot lengthwise						
Information on materials: housing	Epoxy resin PC PET High-alloy stainless steel						

Display/operation	
Switching status indication	Yellow LED

Immission/emission							
Type	SME-8-K	SME-8-K5	SME-8-K-7.5	SME-8-S	SME-8-ZS	SME-8-O	SME-8-SL
Ambient temperature with flexible cable installation [°C]	–5 ... +60	–5 ... +70	–5 ... +70	–5 ... +70	–5 ... +60	–5 ... +60	–
Degree of protection	IP65 IP67			– IP67	IP65 IP67	– IP67	IP65 IP67
Insulation voltage [V]	50						
Surge resistance [kV]	3	3	3	3	3	3	3
Pollution degree	3						

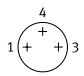
Pin allocation to EN 60947-5-2			
Plug, 3-pin M8x1	Pin	Wire colour	Allocation
	1	Brown	+
	3	Blue	–
	4	Black	Output



## Data sheet – Magnetic reed

### Dimensions

N/O contact, cable

Download CAD data → [www.festo.com](http://www.festo.com)

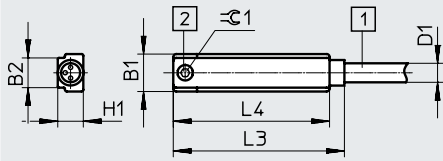

- [1] Connecting cable, 3-wire cable, 3 x 0.14 mm<sup>2</sup>
- [2] Yellow light emitting diode
- [3] Max. tightening torque 0.2 Nm

Type	B1	B2	D1 ∅	H1	L3	L4	≈ 1
SME-8-K- ...	6.4	5	2.9	4.3	28.8	26.3	1.3

### Dimensions

N/C contact, cable

Download CAD data → [www.festo.com](http://www.festo.com)

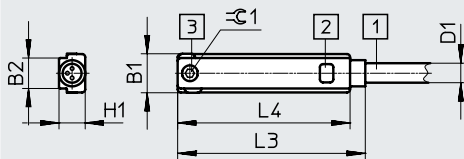

- [1] Connecting cable, 3-wire cable, 3 x 0.14 mm<sup>2</sup>
- [2] Yellow light emitting diode
- [3] Max. tightening torque 0.2 Nm

Type	B1	B2	D1 ∅	H1	L3	L4	≈ 1
SME-8-O-K-LED-24	6.4	5	2.9	4.4	30.8	28.3	1.3

### Dimensions

Plug M8x1

Download CAD data → [www.festo.com](http://www.festo.com)

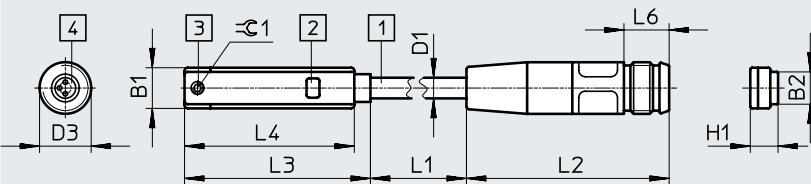



- [1] Connecting cable
- [2] Yellow light emitting diode
- [3] Clamping element
- [4] Plug to fit connecting cable NEBU-M8

L1 Cable length

Type	B1	B2	D1 ∅	D3	H1	L2 +5	L3	L4	L6 min.	≈ 1
SME-8-S-LED-24	6.3	5	2.9	M8	4.7	31	28.8	26.3	6	1.3

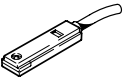
Data sheet – Magnetic reed

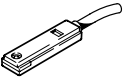
Ordering data							
	Switching output	Electrical connection			Cable length [m]	Part no.	Type
		Cable	Cable with plug M8x1	Plug M8x1			
<b>N/O contact, basic version</b>							
	Contacting, bipolar	3-wire	–	–	2.5	150855	SME-8-K-LED-24
			–	–	5.0	175404	SME-8-K5-LED-24
			–	–	7.5	530491	SME-8-K-7.5-LED-24
	–	3-pin	–	0.3	150857	SME-8-S-LED-24	
	Contacting, bipolar	–	–	–	2.5	171169	SME-8-ZS-KL-LED-24
			–	3-pin	–	526622	SME-8-SL-LED-24
<b>N/C contact</b>							
	Contacting, bipolar	3-wire	–	–	7.5	160251	SME-8-O-K-LED-24

## Data sheet – Magnetic reed

### Function

N/O contact, with cable, 2-wire  
0...30 V AC/DC

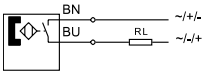

N/O contact, with cable, 2-wire  
3...230 V AC/DC

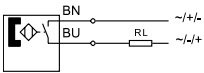

- Magnetic reed measuring principle
- Insertable in the slot lengthwise
- Heat-resistant design
- Variants with operating voltage range up to 230 V DC/AC

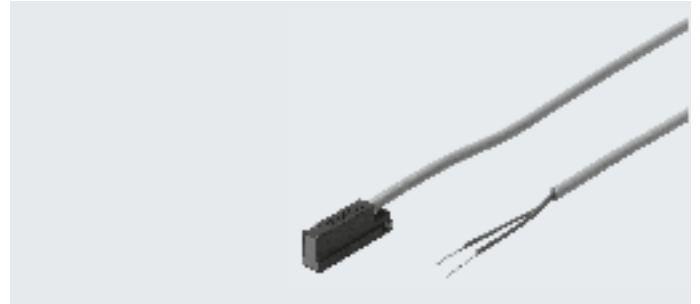

General technical data		SME-8...S6	SME-8...230
Design		For T-slot	
Conforms to standard		EN 60947-5-2	
Certification		–	RCM compliance mark
		–	CCC
CE marking (see declaration of conformity)		–	To EU EMC Directive <sup>1)</sup>
		–	To EU Low Voltage Directive
Note on materials		Free of copper and PTFE	
		RoHS-compliant	

1) For information about the area of use, see the EC declaration of conformity at: [www.festo.com/sp](http://www.festo.com/sp) → Certificates.

If the devices are subject to usage restrictions in residential, commercial or light-industrial environments, further measures for the reduction of the emitted interference may be necessary.

Input signal/measuring element		SME-8...S6	SME-8...230
Measuring principle		Magnetic reed	
Ambient temperature	[°C]	–40 ... +120	–30 ... +60

Switching output		SME-8...S6	SME-8...230
Switching output		Contacting, bipolar	
Switching element function		N/O contact	
Reproducibility of switching value	[mm]	±0.1	±0.1
Switch-on time	[ms]	≤ 0.5	2
Switch-off time	[ms]	≤ 0.03	0.03
Max. switching frequency	[Hz]	800	500
Max. output current	[mA]	500	120
Max. switching capacity AC	[VA]	10	
Max. switching capacity DC	[W]	10	
Voltage drop	[V]	≤ 0	≤ 3.9
Off-state current	[mA]	–	0

## Data sheet – Magnetic reed

Output, additional data		
	SME-8...S6	SME-8...230
Short circuit protection	No	
Overload protection	Not present	
Electronics		
	SME-8...S6	SME-8...230
Operating voltage range [V AC]	0 ... 30	3 ... 230
Operating voltage range [V DC]	0 ... 30	3 ... 230
Reverse polarity protection	No	
Electromechanics		
	SME-8...S6	SME-8...230
Electrical connection	Cable, 2-wire, open end	
Outlet direction of connection	In-line	
Cable length [m]		2.5
Information on materials: cable sheath	TPE-S	TPE-U (PUR)
Mechanics		
	SME-8...S6	SME-8...230
Type of mounting	Clamped in T-slot Insertable in the slot lengthwise	
Information on materials: housing	Epoxy resin	
	PET	
	High-alloy stainless steel	
Information on materials: cable sheath	TPE-S	TPE-U (PUR)
Display/operation		
	SME-8...S6	SME-8...230
Switching status indication	–	Yellow LED
Immission/emission		
	SME-8...S6	SME-8...230
Ambient temperature with flexible cable installation [°C]	–5 ... +120	–5 ... +60
Ambient temperature	–40 ... +120	–
Degree of protection	–	–
	IP67	IP68
Insulation voltage [V]	50	–
Surge resistance [kV]	0.8	4
Pollution degree	3	3

## Data sheet – Magnetic reed

## Dimensions

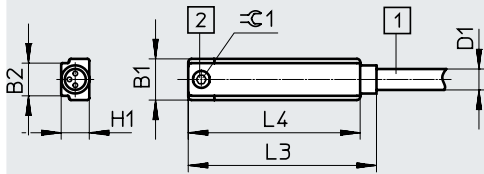
Download CAD data → [www.festo.com](http://www.festo.com)

- [1] Connecting cable, 3-wire cable,  
3 x 0.14 mm<sup>2</sup>
- [2] Max. tightening torque  
0.2 Nm

Type	B1	B2	D1 ∅	H1	L3	L4	±0.1
	±0.05	-0.08	±0.05...-0.1	-0.1		+0.2	
SME-8-...-S6	6.4	5	2.9	4.3	28.8	26.3	1.3

## Dimensions

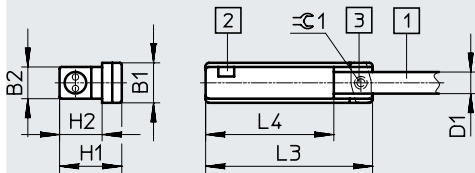
Download CAD data → [www.festo.com](http://www.festo.com)

- [1] Connecting cable
- [2] Yellow light emitting diode
- [3] Max. tightening torque  
0.2 Nm

Type	B1	B2	D1 ∅	H1	H2	L3	L4	±0.1
SME-8-K-LED-230	6.4	5	3.4	9.8	6.7	26.2	20.2	1.3

## Ordering data

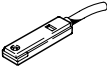
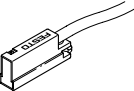
	Switching output	Electrical connection	Outlet direction of connection	Cable length	Weight	Part no.	Type
		Cable		[m]	[g]		
<b>N/O contact, heat-resistant</b>							
	Contacting, bipolar	2-wire, open end	In-line	2.5	50	<b>161756</b>	<b>SME-8-K-24-S6</b>
<b>N/O contact, operating voltage range up to 230 V AC/DC</b>							
	Contacting, bipolar	2-wire, open end	In-line	2.5	39	<b>152820</b>	<b>SME-8-K-LED-230</b>

## Accessories

### Mounting kit SMBR

Material:  
Polyacetal  
RoHS-compliant

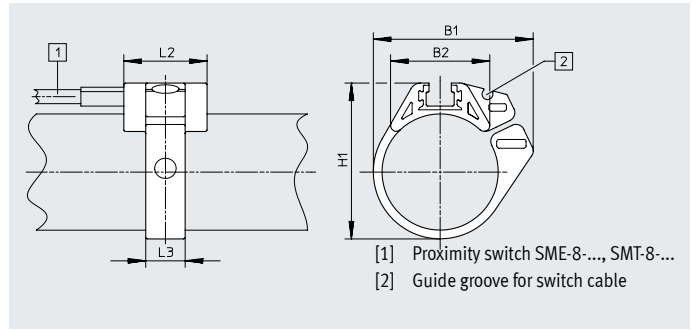

#### Dimensions and ordering data

For piston $\varnothing$	B1	B2	H1	L2	L3	Part no.	Type
8	18.9	12.3	17.5	19	7	175091	SMBR-8-8
10	20.4	13.7	19.9	19	7	175092	SMBR-8-10
12	22.7	14.3	21.9	19	7	★ 175093	SMBR-8-12
16	28.2	16.9	25.7	19	8	★ 175094	SMBR-8-16
20	34.5	20.8	30.4	19	9	★ 175095	SMBR-8-20
25	36.7	22.7	35.6	19	9	★ 175096	SMBR-8-25
32	41.7	24.6	42.7	19	9	175097	SMBR-8-32
40	47.1	26.5	50.7	19	9	175098	SMBR-8-40
50	56.4	28.6	61.5	19	9	175099	SMBR-8-50
63	69.4	32	74.5	19	9	175100	SMBR-8-63

## Accessories

### Mounting kit CRSMB

Design: for round cylinders  
 Type of mounting: any  
 Type of mounting: Glued  
 Degree of protection: IP65, IP68, IP69K  
 Ambient temperature: -40 ... +90°C  
 Material:  
 Housing: anodised aluminium,  
 TPE-U(PU)  
 Free of copper and PTFE  
 RoHS-compliant  
 PWIS conformity:  
 VDMA24364-B2-L

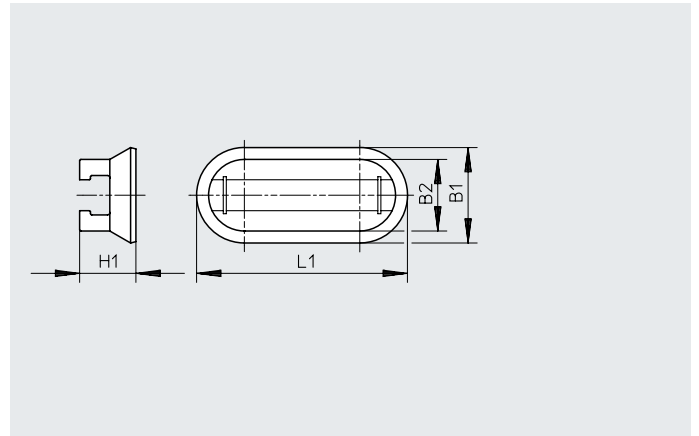

Ordering data									
For piston $\varnothing$	B1	B2	H1	L1	CRC <sup>1)</sup>	Part no.	Type		
32 ... 100	15.8	11.8	9.3	35	4	525565	CRSMB-8-3 2/100		

1) Corrosion resistance class CRC 4 to Festo standard FN 940070

Particularly high corrosion stress. Outdoor exposure under extreme corrosive conditions, e.g. in the chemical or food industries. Such applications may need to be safeguarded by means of special testing (→ also FN 940082), using appropriate media.

### Mounting kit SMB-8-FENG

Material:  
 Wrought aluminium alloy  
 Free of copper and PTFE

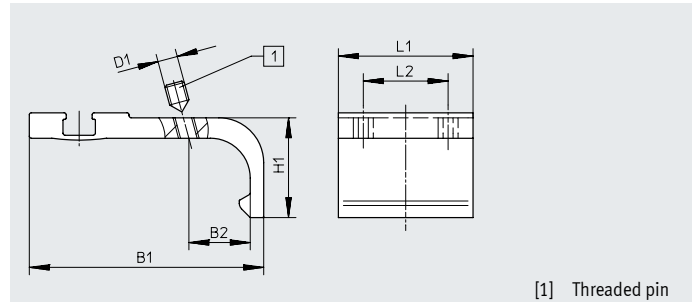
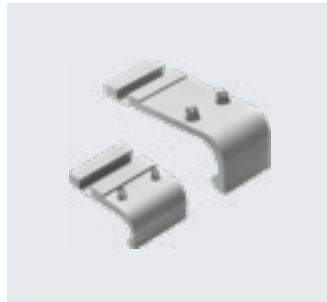

[1] Threaded pin

Dimensions and ordering data									
For piston $\varnothing$	B1	B2	D1	H1	L1	L2	Tightening torque [Nm]	Part no.	Type
32/40	35.1	8.7	M3	15.5	27	17	0.2	175705	SMB-8-FENG-3 2/40
50/63	47	12.3	M4	20	27	17	0.5	175706	SMB-8-FENG-50/63
80/100	64.3	15.7	M5	24.3	27	17	0.7	175707	SMB-8-FENG-80/100

## Accessories

### Positioning element SMM

Insertable in the slot lengthwise

Ambient temperature: -40 ... +120°C

Materials:

Housing: anodised wrought aluminium alloy

Screws: high-alloy stainless steel

Note on materials: RoHS-compliant

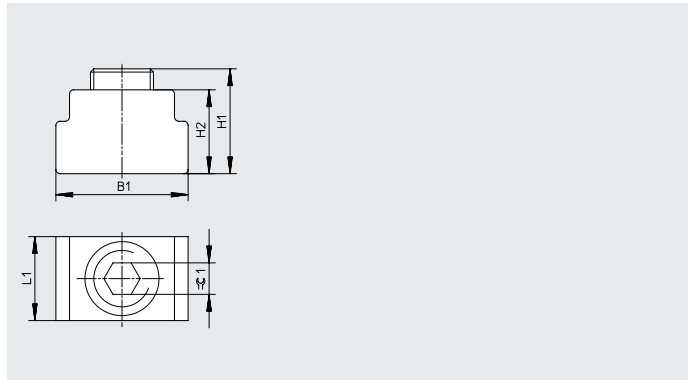

#### Dimensions and ordering data

B1	H1	H2	L1	$\approx \ominus 1$	CRC <sup>1)</sup>	Part no.	Type	PU <sup>2)</sup>
6.3	5.0	4.0	4.0	1.5	3	547941	SMM-8	10

1) Corrosion resistance class CRC 3 to Festo standard FN 940070

High corrosion stress. Outdoor exposure under moderate corrosive conditions. Externally visible parts with primarily functional surface requirements which are in direct contact with a normal industrial environment.

2) Packaging unit

### Sensor bracket DASP-M4-...-A

Material:

Anodised wrought aluminium alloy

Screws: high-alloy stainless steel

RoHS-compliant

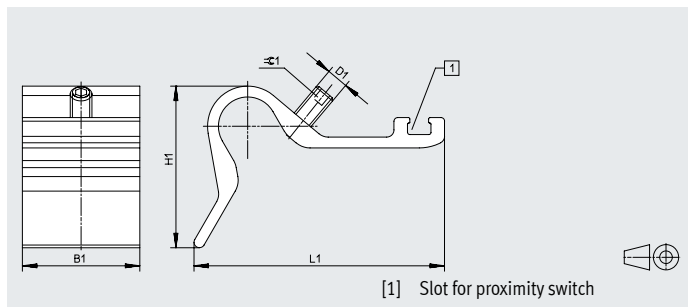

[1] Slot for proximity switch

#### Dimensions and ordering data







Type	B1	D1	H1	L1	$\approx \ominus 1$	Tightening torque [Nm]	CRC <sup>1)</sup>	Weight [g]	Part no.	Type
DASP-M4-125-A	32.5	M5	28	45.4	2.5	1	3	26.5	1451483	DASP-M4-125-A
DASP-M4-160-A	32.5	M6	44.7	69.4	3	1	3	41.5	1553813	DASP-M4-160-A
DASP-M4-250-A	32.5	M6	56.3	88	3	1	3	60	1456781	DASP-M4-250-A
DASP-M4-320-A	32.5	M6	56.3	88	3	1	3	60	3015256	DASP-M4-320-A

1) Corrosion resistance class CRC 3 to Festo standard FN 940070

High corrosion stress. Outdoor exposure under moderate corrosive conditions. Externally visible parts with primarily functional surface requirements which are in direct contact with a normal industrial environment.



## Accessories

Ordering data – Connecting cables		Number of wires	Cable length [m]	Part no.	Type	Data sheets → Internet: nebu/sim
<b>Socket M8x1, 3-pin</b>						
	For SMT/SME-8... and SMT0/SMTSO/SME0-8E	3	2.5	★ 541333	NEBU-M8G3-K-2.5-LE3	
			5	★ 541334	NEBU-M8G3-K-5-LE3	
	For SMT/SME-8... and SMT0/SMTSO/SME0-8E	3	2.5	★ 541338	NEBU-M8W3-K-2.5-LE3	
			5	★ 541341	NEBU-M8W3-K-5-LE3	
<b>Socket M12x1, 5-pin</b>						
	For SMT/SME-8M and SMT0/SMTSO/SME0-8E	3	2.5	★ 541363	NEBU-M12G5-K-2.5-LE3	
			5	★ 541364	NEBU-M12G5-K-5-LE3	
	For SMT/SME-8M and SMT0/SMTSO/SME0-8E	3	2.5	541367	NEBU-M12W5-K-2.5-LE3	
			5	541370	NEBU-M12W5-K-5-LE3	
<b>Socket M12x1, resistant to welding spatter</b>						
	For SDBT and SMTSO	3	3	30450	SIM-M12-RS-3GD-3	
	For SDBT and SMTSO	3	3	30451	SIM-M12-RS-3WD-3	

Ordering data – Safety clip for ATEX zone					
	Size	Description	Part no.	Type	PU <sup>1)</sup>
	M8	<ul style="list-style-type: none"> <li>Protects "equipment that is not intrinsically safe" in zones 2 and 22 against simple disconnection</li> <li>ATEX category: gas: II 3G / dust: II 3D</li> </ul>	548067	NEAU-M8-GD	1
	M12		548068	NEAU-M12-GD	1

1) Packaging unit

Ordering data – Mounting components			
	Description	Part no.	Type
	For fixing connecting cables in place	534254	SMBK-8

Ordering data – Sensor tester			
	Description	Part no.	Type
	<ul style="list-style-type: none"> <li>Testing the functionality of proximity switches using the integrated voltage supply</li> <li>Adjusting proximity switches on the cylinder</li> </ul>	158481	SM-TEST-1

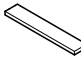
Ordering data – Inscription labels				
	Size	Part no.	Type	PU <sup>1)</sup>
	23x4 mm	541598	ASLR-L-423	34

1) Packaging unit